

## COMPARATIVE STUDY OF SEISMIC STRENGTHENING TECHNIQUES FOR ADOBE STRUCTURES

Chintan D. Patel<sup>1</sup>, Tarak Vora<sup>2</sup>

<sup>1</sup> Research Scholar, Department of Civil Engineering, Marwadi University, Rajkot, Gujarat, India.

<sup>2</sup> Professor, Department of Civil Engineering, Marwadi University, Rajkot 360003, Gujarat, India.

### ABSTRACT

*Adobe is a commonly used building material in rural areas, but it experiences significant damage during earthquakes. This study aims to improve the seismic behavior of rural adobe (mixture of clay and sand) houses by comparing different seismic strengthening techniques through conducting a series of tests on 7 reduced scale adobe models. Reduced scale of 1:5 was adopted for model structures. Firstly, the tests regarding soil classification is performed on the adobe soil. Additionally, the mechanical behavior of reduced scale adobe bricks was evaluated through axial compression tests. Shake table test was performed on unreinforced and reinforced adobe reduced scale models. The models were tested on shake table with frequency range 0-25 Hz. Model U1, representing a typical adobe structure without any strengthening measures, and Model A1 and A2, which were reinforced with strategically placed cold-formed steel strips, model B1 and B2 reinforced with geo-grid mesh and C1 and C2 reinforced with strategically placed hemp fibre ropes. The capacity curve theory is used to draw graph between base shear coefficient and drift ratio to determine energy absorption and seismic resistance. A comparative analysis was performed using the capacity curve. The result shows that base shear resistance of geogrid is highest among all the strengthening material. The maximum base shear coefficient of hemp-fibre reinforced models is 2.227, models reinforced with cold-formed steel is 3.4882 and of geogrid reinforced is 5.284.*

*Keyword : - Vernacular structures, adobe buildings, seismic behaviour, seismic strengthening, coldformed steel reinforcement, geogrid, hemp fibre, earthquake resistance.*

### 1. INTRODUCTION

Vernacular adobe structures, rooted in local or regional construction practices, have long been a prominent form of architecture in many parts of the world. These structures are characterized by their use of traditional materials and resources obtained from the surrounding environment, making them closely intertwined with the local culture, climate, and geography [3].

Adobe, a mixture of clay, sand, water, and organic materials such as straw, has been a favored material for constructing vernacular homes in rural areas. Its availability, affordability, and thermal properties make it an attractive choice for meeting the housing demands of rural communities. The use of adobe bricks, which are sun-dried rather than kiln-fired, is a hallmark of vernacular adobe construction. However, despite their advantages, conventional adobe buildings face significant challenges, particularly in terms of their vulnerability to seismic events. Earthquakes can cause catastrophic damage to these structures, leading to a loss of life and property. The inherent brittleness and lack of structural integrity of adobe construction contribute to their seismic vulnerability. The seismic failures observed in adobe structures can be attributed to the inability of the material to withstand the dynamic forces exerted during earthquakes. The brittle nature of adobe makes it prone to cracking and collapsing under seismic loads [1]. The absence of reinforcement or structural elements further exacerbates their vulnerability. Recognizing

the need to enhance the seismic resilience of vernacular adobe homes, research efforts have been directed towards investigating methods to reinforce and strengthen these structures.

## 2. DETAIL PLAN AND GEOMETRY OF STRUCTURE

At a scale of 1:5, total of 7 reduced scaled models of adobe masonry structures were made. All of the models were made out of scaled adobe bricks. Details plan and elevation of structures are shown in figure 1.

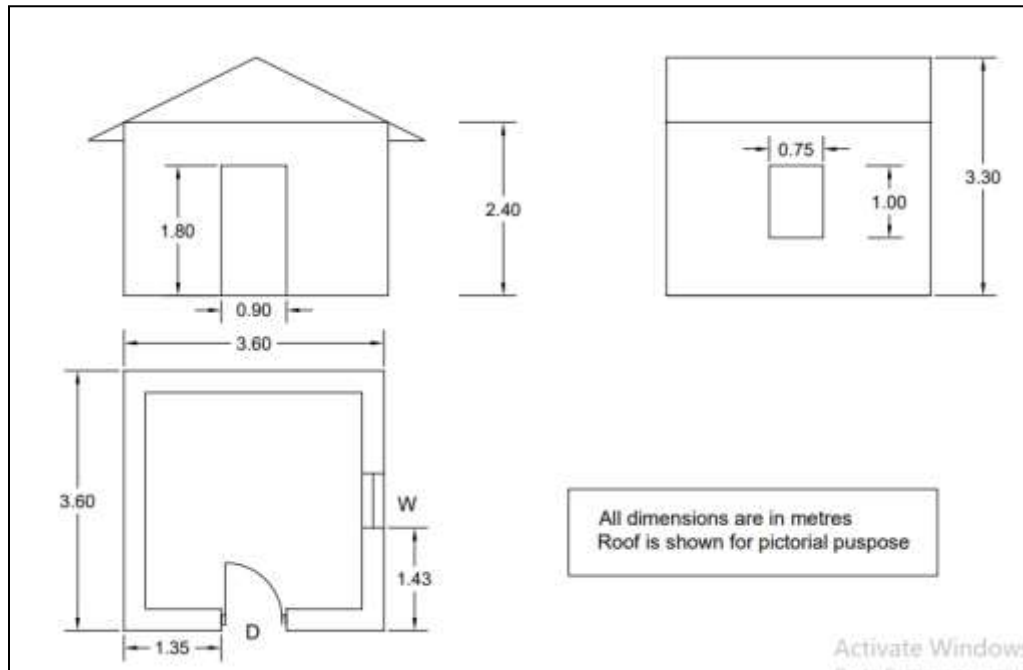

**Fig 1** Plan of Structure

### 2.1 Model Similitude

There should be a resemblance between the prototype and model through the rules which can relate geometry, material properties, initial conditions, and boundary conditions between them.

To satisfy the modeling requirements for dynamic testing, models without the simulation of gravity forces are considered. For lower-storey houses (In this case Single storey), the stresses induced by gravitational forces are small compared to the stresses induced by seismic forces. So due to the negligible effect of gravity forces, there is no need to simulate gravitational forces. For the reduced scale of 1:5, the following are the transformations from the model domain to the prototyping domain.

For, Frequency,  $f(\text{Prototype}) = f(\text{Model})/5$   
 Time,  $t(\text{Prototype}) = t(\text{Model})/5$   
 Force,  $F(\text{Prototype}) = F(\text{Model}) \times 25$   
 Displacement,  $\delta(\text{Prototype}) = \delta(\text{Model}) \times 5$

Acceleration,  $a(\text{Prototype}) = a(\text{Model})/5$

### 3. MATERIAL SPECIFICATION AND ITS PROPERTIES

The first part of the study focused on a material testing program to evaluate the properties and characteristics of adobe material. This involved conducting tests on both prototype and reduced-scaled adobe samples to analyze any differences in behavior.

To determine the appropriate material proportion, three cubes of size 70.6×70.6×70.6 mm were casted using different clay-to-sand ratios. Cube 1 had a clay-to-sand ratio of 60:40, Cube 2 had a ratio of 50:50, and Cube 3 had a ratio of 40:60. After sun drying the cubes for 14 days, it was observed that none of the cubes had developed any cracks. Based on this observation, it was decided to use a clay-to-sand proportion of 60:40 for the adobe material. The clay and sand were mixed uniformly using a mechanical mixer, and straw was also added to the mix. The addition of straw is beneficial in binding the bricks together and facilitating even drying, thereby preventing cracking due to uneven shrinkage rates. This material testing program provided essential insights into the behavior of adobe material and helped determine the optimal clay-to-sand proportion for the subsequent testing phase. By ensuring the homogeneity of the mixture and incorporating straw, the study aimed to improve the overall structural integrity and performance of adobe bricks in the subsequent static and dynamic testing of reduced-scaled adobe house models.

**Table 1** Adobe Soil properties

Colour of soil	Type of Soil	Bulk Density of Soil (g/cm <sup>3</sup> )	Clay Content in %	Sand Content in %
Brown Soil	Clayey, Highly Compressible Soil (CH Soil)	1.89	60	40

**Table 2** Brick Specification

Brick Size	Full Scaled (in Cm)			Reduced Scale (1:5) (in Cm)		
	L	B	H	L	B	H
Adobe Bricks	25	30	8	5	6	1.8

#### 3.1 Strengthening materials

##### Cold Formed Steel

Cold-formed steel is not typically used as a reinforcement material in adobe masonry structures, it has been proposed as a potential solution to enhance their seismic performance [9]. Cold-formed steel framing involves the use of thin, lightweight steel sections that are fabricated by bending, rolling, or pressing flat sheets of steel. These sections can be prefabricated and easily transported to the construction site, making them a cost-effective and time-efficient solution for low-income housing projects. One of the key advantages of cold-formed steel is its high strength-to-weight ratio, which allows it to resist seismic loads and provide additional stability to adobe masonry structures [2]. Cold-formed steel can be used to create a lightweight and flexible frame that can accommodate the differential movements and settlements that occur during earthquakes. The use of cold-formed steel can also improve the structural integrity of adobe masonry walls and provide better connections between the adobe blocks, which can help prevent the walls from collapsing during seismic events. Research studies have investigated the use of cold-formed steel in conjunction with adobe masonry in seismic-resistant building design. These studies have evaluated the behavior of adobe masonry structures reinforced with cold-formed steel frames under simulated earthquake loading conditions. The results have shown that the use of cold-formed steel can significantly improve the seismic performance of adobe masonry structures, reducing the risk of collapse and improving the safety of the occupants. Overall, while cold-formed steel is not a traditional material used in adobe masonry construction, it has the potential to enhance the seismic performance and structural integrity of these buildings. Its high strength-to-weight ratio, ease of fabrication, and flexibility make it a promising solution for low-cost and sustainable housing projects in seismic-prone areas.

### **Geogrid**

Geogrid is a type of geo-synthetics that is a synthetic product, usually made from or including polymeric materials, that are used to solve civil and geotechnical engineering problems. Geogrid has been used for enhanced performance against seismic loading in Embankments, Earth retaining structures, etc. Geogrids work by interlocking with the granular or fine material placed over them. The apertures allow for strike-through of the cover soil material which then interlocks with the ribs (flat straps/bars) providing confinement of the overlaying granular/soil material due to the stiffness and strength of the ribs. The advantages of geogrid are that they result in more economical construction, are environmentally friendly, and ensure ease of construction as the placement techniques are simple. Geogrid is woven and coated with PVC which is inert to biological and chemical degradation.

Here geogrid used is CTMGGU 100/30. Here 100/30 means it has the ultimate tensile strength of 100 kn/m in the machine direction of the geogrid and 30 means it has 30 kn/m of ultimate tensile strength in the perpendicular direction of the geogrid [11].

### **Hemp fibre rope**

Hemp fibre rope is a natural fibre rope made from the stems of the hemp plant. Hemp fibre is known for its strength, durability, and resistance to moisture, making it a popular material for use in various applications, including rope making. Hemp fiber has been studied as a potential material for seismic strengthening in construction. Seismic strengthening refers to the process of retrofitting existing buildings to improve their ability to withstand earthquakes. One of the properties that make hemp fiber a potentially effective material for seismic strengthening is its high tensile strength. Hemp fiber also has good adhesion to cement and other building materials, which allows it to be integrated into concrete or mortar to reinforce structures. The test is usually conducted using a tensile testing machine, which applies an increasing load to the rope until it breaks.

### 3.2 Physical and Mechanical Properties of Adobe

Standard proctor test, liquid limit, plastic limit tests were performed to classify the soil. It was found that the MDD was 1.71 g/cc and the OMC was 16% through the standard proctor test. From the liquid limit and plastic limit test the liquid limit and plastic limit were 0.53 and 0.1933 respectively. So, the soil was classified as CH type of soil.

Compressive strength test was performed to determine the compressive strength of adobe specimen. Three adobe specimen were tested for compressive strength. It was comes out to be 3.14Mpa as shown in table below.



**Fig 2** Compression testing of adobe specimen

**Table 3** Compressive strength of adobe specimen

Sr.no.	L(mm)	W(mm)	H(mm)	Peak Load (Kn)	Comp.Strength (Mpa)	Avg.Comp. Strength (Mpa)
1	129.6	134.4	133.1	53.5	3.07	3.14
2	137.7	139.7	140.8	71.5	3.72	
3	136.65	140.8	134.4	50.5	2.62	

A test was conducted to determine the flexural strength of an adobe brick with dimensions of 250 mm x 300 mm x 80 mm. The test results showed that the flexural strength of the brick was 2.9 Mpa. According to the guidelines set forth in NZS 4298 for materials and workmanship in earth buildings, the recommended minimum flexural strength is 0.25 Mpa [15]. Therefore, the brick's flexural strength is greater than the recommended value.

### 4. CONSTRUCTION OF REDUCED SCALE MODEL

This section presents the theory behind dynamic testing of reduced-scale models and its application in this project. Three model buildings were constructed and tested, with each model having an identical plan and wall layout [14]. However, the strengthening techniques applied to the walls differed for each model. Model

U1 was the base model with no strengthening technique. The construction of each model is briefly discussed in this section.

U1, A1, A2, B1, B2, C1 and A2 reduced Adobe masonry models were casted. The parameters that separate the models are listed here.

**U1** : First model was a simple reduced scale adobe brick masonry structure with no extra or additional features.

**A1** : A1 model has same geometry as first model but to improve dynamic characteristic cold formed steel strips are used near the openings, corners and at lintel level.

**A2** : A2 model has also the same geometry as further two models but to strengthen the adobe masonry structure grid pattern is made using cold formed steel strips.



**Fig 3** Model U1



**Fig 4** Model A1



**Fig 5** Model A2

**B1** : Model B1 was strengthened with the wall surface strengthening technique with geogrid as a confinement reinforcement. Wall surface strengthening is a technique that is most widely used and easy to apply for any type of structure. Here in Model A2, polypropylene strips are used to tie the geogrid to the wall surface. While making the model buildings, these strips were placed in the bed joint of the successive brick layers, and after the completion of the model, geogrid was tied internally and externally with these strips.

**B2** : Model B2 was strengthened with the bed-joint strengthening technique with geogrid as a bed-joint reinforcement. Most strengthening uses wall-surface strengthening, which requires good surface preparation, as irregularities can cause poor bonding and delamination. The other hindrances of this method were vulnerability to environmental impacts like fire, moisture, frost, etc. Bed joint strengthening is an effective solution to overcome such problems. So, due to these reasons, in Model B2 bed-joint strengthening technique is used to resist the seismic forces. Geogrid is placed in alternate layers and accordingly, strips are made and laid down in the bed joint of the masonry layer.

**Fig 6 Model B1****Fig 7 Model B2**

**C1** : Model C1 is a adobe masonry model with the use of hemp fibre rope in a grid form as a wall surface seismic strengthening technique which is connected with the horizontally placed shred of ropes.

**C2** : Model C2 is also a similar reduced-scale adobe masonry model with a difference of using hemp fibre rope as a seismic strengthening technique for wall junctions.

**Fig 8 Model C1****Fig 9 Model C2**

## 5. TEST AND RESULTS OF MODEL STRUCTURE

After the construction of all 7 models testing of the models can be started. Two tests were conducted on each constructed masonry models. First test was Impact hammer test to determine the dynamic characteristic of models like Natural time period and Damping. Second test was shake table test to get the failure and damage pattern of models.

### 5.1. Impact Hammer Test

An impact hammer test was conducted to determine the natural time period and damping of models. Different instruments which were used in the experiment are Impact Hammer, Accelerometer, sixteen channel vibration analyser instruments, Data cable & Computer with NV gate software.

Fix the model structure on the shake table and put the required calculated weight of 32 kg on the roof of the structure. Attach sensors to their positions on the model and make sure all the sensors and impact hammer are connected to sixteen-channel vibration analyzers. After all connections are made properly, run NV gate software and strike the impact hammer horizontally to the wall of the modeled structure at the

hammering place. Record the free vibrations of the structure produced due to hammering and obtain acceleration vs. time plot. Measure the time period required to complete one cycle of vibration to obtain the time period T. Measure the peak acceleration A1 at time t1 and acceleration another any particular acceleration A2 at time t2 and compute the damping ( $\xi$ ) from the following Equation.

$$\xi = \frac{1}{n \times 2\pi} \ln \frac{A_1}{A_2}$$

However, the above equation is for the vibrations related to uniform accelerated motion while the model masonry structure does not perform uniform motion. But to find the Approx. value of damping above decay in motion related to model masonry structure can fairly be assumed to be uniform by selecting peak acceleration and low acceleration data. Repeat the process to get finer data and analyze collected data for final results.

## 5.2 Shake Table Test

Shake table testing was done for all modeled masonry structures to observe the effect of seismic strengthening techniques (geogrid as wall-surface strengthening and bed-joint strengthening) on the failure mode of the structure [4]. Different instruments which were used in the experiment are Shake Table, Accelerometer, sixteen channel vibration analyzer instruments, Data cable & Computer with NV gate software.

Specifications of low-frequency shake table:

- Design Payload of Approximately 200 kg
- Peak Acceleration 5g
- Operational Frequency Range 0–25 Hz
- Sliding Table Dimensions 3 ft x 5 ft
- Motor capacity 1 HP

Fix the model structure on the shake table and put the required calculated weight of 32 kg on the roof of the structure. Attach sensors to their positions on the model and make sure all the sensors are connected to Sixteen channel vibration analyzer. After all connections are made properly, run NV gate software and start the shaking of the shake table from an initial frequency of 1 Hz with an initial displacement of 15 mm and 5 No. of cycles. Record the collected data from the sensors and save the file, after that frequency has to be increased subsequently until the model fails. All the data for each frequency has to be recorded and saved in digital format.

Data collected from sixteen channel analyzer based on the base acceleration, applied frequency, acceleration at the roof level of the model structure, and displacement at the top of the structure were found out for each shaking. There are three different inputs frequency, displacement, and No. of cycles to be provided to the shake table. However, the input frequency is the frequency of the servo motor which empower the shake table unit may differ from the actual frequency applied at the base of the shake table where the prepared models are to be rested.

**Table 4** Results of Impact Hammer test

Model	Natural Time period ( Tn )	Damping ( $\xi$ ) %
U1	0.008	1.54



A1	0.009	2.67
A2	0.01	4.61
B1	0.006	2.24
B2	0.01	2.67
C1	0.01	1.572
C2	0.011	1.551

Following are the figures which shows all the models before and after the testing on shake table.



**Fig 10** Model U1 on Shake Table



**Fig 11** Model A1 on Shake Table



**Fig 12** Model A2 on Shake Table



**Fig 13** Collapse of Model U1



**Fig 14** Collapse of Model A1



**Fig 15** Collapse of Model A2



**Fig 16** Model B1 on Shake Table



**Fig 17** Model B2 on Shake Table

**Fig 18** Collapse of Model B1**Fig 19** Collapse of Model B2**Fig 20** Model C1 on Shake Table**Fig 21** Model C2 on Shake Table**Fig 22** Collapse of Model C1**Fig 23** Collapse of Model C2

All 7 models were tested on shake table for dynamic response of structures. The failure pattern was observed through dynamic testing of modeled structure on shake table testing. From the data collected from the shake table testing of all seven models the graph is plotted between the base shear coefficient and drift ratio. Capacity curve for all 7 models in the form of Base shear coefficient (BSC) vs. Drift ratio is to be plotted. Drift ratio is the ratio of the top lateral displacement to the height of the structure and is expressed in percentage drift. Base shear is calculated by multiplying the maximum response acceleration at the top of the structure with the storey mass, while storey mass can be taken as the sum of the mass of roof and half of the mass of the walls. The advantage of comparing capacity in terms of BSC instead of PGA (Peak ground acceleration) is that it provides uniform standard for comparing performances of structures subjected to varied testing regimes, and thus similar structures tested anywhere in the world can be conventionally compared without giving specific importance to input excitation and PGA. Following is the graph of base shear coefficient vs drift ratio which is obtained by shake table testing of models.

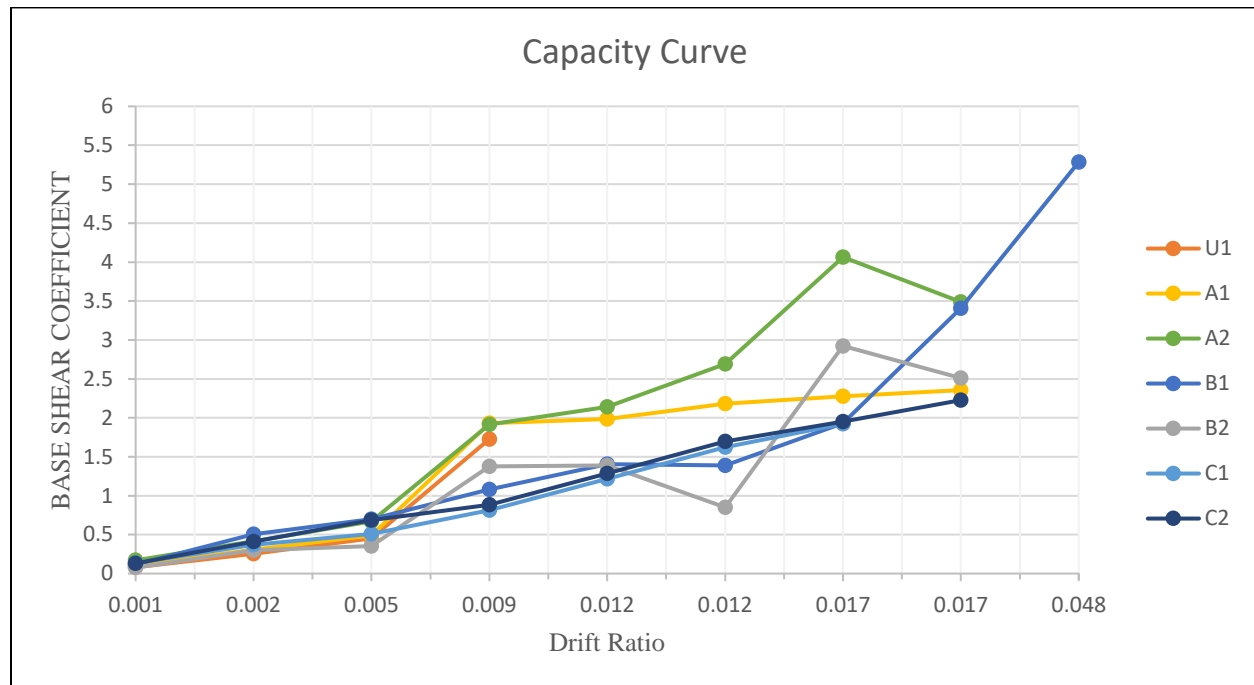

**Fig 23** BSC vs. Drift ratio (%) curves for Model masonry structures

From the above below following observations are made

- Seismic resistance of model B1 is significantly larger than the other six models.
- Capacity curve of model A1 shows competitively lesser values of BSC for corresponding drift ratio compared to other models. This shows very low energy absorption for model A1.
- Both U1 and A1 models reach their ultimate capacity at drift ratio (%) around 0.028, however BSC corresponding to model A2 is slightly higher than the BSC corresponding to model A3.
- Capacity curve for all seven models are nearly equal up to the drift ratio of 0.002.
- For Drift ratio of 0.01 to 0.03, less deformation or damage and cracks observed in model A1 for same amount of acceleration than model A2. After that Model A2 fails which shows brittle behaviour of the structure.
- Models A1,A2,B2 and C2 has same drift ratio at the point of failure.
- Models A2 and B2 reaches ultimate drift ratio after reaching the ultimate BSC which shows ductile behavior of these structures.
- Capacity curve for model C1 and C2 is nearly equal up to drift ratio of 0.025.

## 6. CONCLUSION

In conclusion, the research on using three different materials as a seismic strengthening for adobe construction has provided valuable insights and findings. Based on the conducted study, the following conclusions can be drawn

- The conventional technique of using Geogrid material as wall-surface strengthening provides the best output results which can be seen in the capacity curve of all the models. The unconventional technique of bed-joint strengthening also appears to be significantly more resistant than the structure without any strengthening aid but the amount of the maximum base shear carried by it was lesser than the wall-surface strengthening.
- Lesser environmental impact and economic savings of Bed-Joint strengthening also favor the use of geogrid as a bed-joint strengthening technique. So, in the areas where the influence of the earthquake is not much higher as compared to seismic-prone areas, the use of geogrid as a bed-joint strengthening can be emphasized. Damping of the adobe masonry models with the strengthening techniques varies with the one with no strengthening techniques and the damping of the Model A2 and A3 was almost the same.
- The research demonstrates that the use of cold-formed steel effectively controls and mitigates cracks in adobe structures subjected to seismic loading. The steel elements distribute stress and provide reinforcement, reducing the formation and propagation of cracks. This mechanism significantly improves the durability and longevity of adobe walls.
- The damping of reinforced model of adobe by using cold formed material is more as compared to the unreinforced model.
- One of the notable findings is that incorporating cold-formed steel as seismic strengthening in adobe construction is compatible with traditional building practices. The integration of steel elements does not disrupt the traditional aesthetic and construction methods associated with adobe buildings, allowing for a harmonious blend of modern strengthening techniques with traditional architectural styles. But we talk about compatibility in the form of utilizing the tensile capacity of cold form steel it does not utilise up to the full capacity. The adobe fails before the cold formed steel breaks. The failure in the steel is just like it yields and it breaks from connection between adobe and cold formed steel strips.
- The research confirms that incorporating hemp fibre rope as seismic strengthening in adobe construction can be an effective solution. The use of hemp fibre rope improves the structural performance and enhances the seismic resilience of adobe walls. The rope acts as a flexible element, providing additional tensile strength and improving the overall ductility of the structure. This results in improved structural integrity, reduced displacement, and increased safety during seismic events.
- The research suggests that using hemp fibre rope as seismic strengthening can be a cost-effective solution compared to conventional reinforcement methods. Hemp fibre ropes are relatively affordable and readily available, making them an attractive option for seismic retrofitting or new construction projects in regions where adobe construction is prevalent.
- Use of Hemp fibre ropes as a uniformly spaced grid contributes to the confinement of the Adobe wall and also it increases the ductility of the Adobe structure.
- In the Model C2, the junction of the perpendicular walls and the adjacent part of the opening is effectively strengthened by use of hemp fibre ropes. When the collapse of the structure occurred, the masonry part of the junction fails as a single unit and so it indicated that the hemp fibre ropes significantly improves the strength of the masonry near the junction as well as at the window and door openings.

## 7. REFERENCES

1. Innocent Kafodyaab , F Okontaa , Panos Kloukinasc “Role of fiber inclusion in adobe masonry

- construction” Elsevier: Journal of Building Engineering,2019
2. Jun Yea , Jurgen Becquea, Iman Hajirasoulihaa , Seyed Mohammad Mojtbaeia , James B.P. Limb “Development of optimum cold-formed steel sections for maximum energy dissipation in uniaxial bending”Elsevier: Engineering Structures,2018
  3. Javier Ortega, Graca Vasconcelos, Hugo Rodrigues, Mariana Correia, Paulo B. Lourenco “Traditional earthquake resistant techniques for vernacular architecture and local seismic cultures: A literature review” Elsevier : Construction and Science Direct,2017
  4. B. Samali, D.M. Dowling & J. Li “Dynamic Testing and Analysis of Adobe-Mudbrick Structures” Taylor & Francis,2017
  5. A.P. Olukoya Obafemia,, Sevinç Kurtb “Environmental impacts of adobe as a building material: The north cyprus traditional building case” ELSEVIER,2015
  6. Dora Silveira, Humberto Varum , Aníbal Costa “Influence of the testing procedures in the mechanical characterization of adobe bricks” Elsevier 2012
  7. Dora Silveira, Humberto Varum, Aníbal Costa, Henrique Pereira, Laura Sarchi, Ricardo Monteiro “Seismic behavior of two Portuguese adobe buildings: Part I - in-plane cyclic testing of a fullscale adobe wall” Elsevier 2012
  8. L Memba Ikuga, Ramon Lull University, Barcelona, Spain & T Murray; ‘Vernacular Housing’; University of Missouri, Columbia, MO, USA ©2012 Elsevier Ltd
  9. Juan C. Reyes , Raul Rincon , Luis E. Yamin , Juan F. Correal , Jose G. Martinez , Juan D. Sandoval , Cristian D. Gonzalez , Christiam C. Angel “Seismic retrofitting of existing earthen structures using steel plates” Elsevierr : Materials and Structures,2012
  10. B. Samali, W. Jinwuth, K. Heathcote and C. Wang ; “Seismic Capacity Comparison Between Square And Circular Plan Adobe Construction”; Procedia Engineering (EASEC12) Vol. 14 -2011 (p.g. no: 2103-2108)
  11. J.F. Tipler, M.L. Worth, H.W. Morris & Q.T. Ma ; “Shake Table Testing Of Scaled Geogrid-reinforced Adobe Wall Models”; NZSEE 2010 Conference
  12. Structural Characterization and Seismic Retrofitting of Adobe Constructions Experimental and Numerical Developments (springers)
  13. Seismic Studies on Small-scale Models on Adobe Houses By y E. Leroy Tolles III and Helmut Krawinkler A report on a research project sponsored in part by the National Science Foundation Grant CEE-8311150 (REPORT NO. 91, October1990)
  14. IS 13828 (1993): Improving earthquake resistance of low strength masonry buildings – Guidelines
  15. NZS 4298: Materials and workmanship for earth buildings